

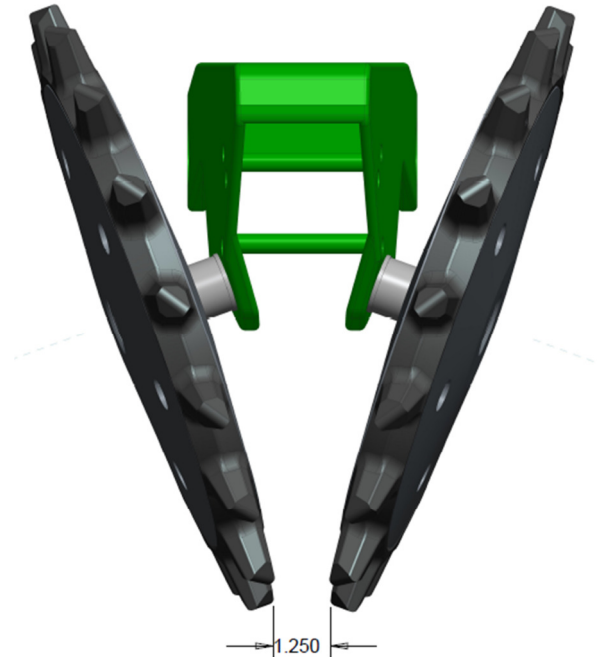

6200 POLY SPIKE CLOSING WHEEL

6200-005 AND 6200-006 INSTALLATION INSTRUCTIONS 2565-797_REV_B
FOR JD 1700 (ALL MODELS), KINZE & WHITE PLANTERS WITH V-CLOSING WHEELS

1. REMOVE THE RUBBER CLOSING WHEEL FROM THE PLANTER
2. REMOVE BOLTS FROM RUBBER CLOSING WHEEL HUBS
3. DISASSEMBLE THE RUBBER CLOSING WHEEL
NOTE: DO NOT ATTEMPT TO PRY THE WHEEL APART, YOU WILL DAMAGE THE HUBS.
4. REMOVE THE RUBBER TIRE.
5. INSTALL THE 6200 POLY SPIKE IN SAME LOCATION AS THE RUBBER TIRE.
6. VERIFY OUTER LIP ON CLOSING WHEEL HALVES ARE FULLY SEATED AND TIGHT IN THE GROOVE OF 6200 POLY SPIKE WHEEL.
7. RE-INSTALL BOLTS AND HEX NUTS. FULLY TIGHTEN
8. WHEN MOUNTING ON THE PLANTER, USE WASHERS PROVIDED OR EXISTING SPACERS TO POSITION THE 6200 POLY SPIKE WITH 1-1/4" APART AT THE CLOSEST POINT. REFER TO THE ILLUSTRATION
9. 6200 POLY SPIKE WHEELS ARE TYPICALLY INSTALLED STRAIGHT ACROSS FROM EACH OTHER AND IN THE BACK HOLE.
10. THE DISTANCE BETWEEN WHEELS MAY NEED TO BE ADJUSTED ACCORDING TO SOIL CONDITIONS. SOIL CONDITIONS VARY SO IT WILL BE NECESSARY TO CHECK FOR SEED TO SOIL CONTACT AS CONDITIONS CHANGE.



JOHN DEERE 7000/7100 AND KINZE (PRE-1993) WITH THE WATER PUMP STYLE BEARINGS WILL REQUIRE A 6200-143 STUD ADAPTER KIT.

YETTER MANUFACTURING CO.
FOUNDED 1930

Colchester, IL 62326-0358
Toll free: 800/447-5777
309/776-3222 (Fax)
Website: www.yetterco.com
E-mail: info@yetterco.com

GERMINATE UNIFORMITY™



6200-005 POLY SPIKE CLOSING WHEEL KIT

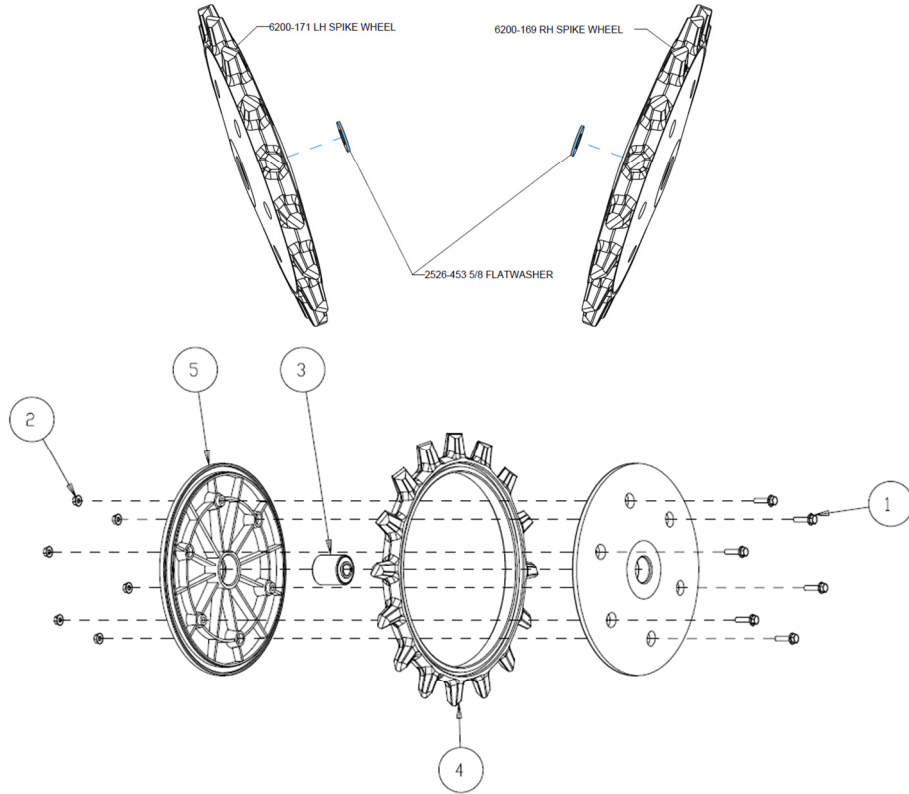

ITEM	PART NO.	DESCRIPTION	QTY
1	2502-111	M6X1X25MM,GR8-8,FL HH BOLT ZP	6
2	2520-160	M6X1.0,CRIMP LOCK FL NUT ZP WAXED	6
3	2570-069	40MM BEARING - AN202132 (S283KY2)	1
4	6200-454	POLY SPIKE WHEEL RH, 16 TOOTH(SHOWN)	1
	6200-458	POLY SPIKE WHEEL LH, 16 TOOTH	1
5	6200-455	WHEEL HALF, NYLON	2

6200-006 POLY SPIKE CLOSING WHEEL "INSERT" KIT

